

1050
1543

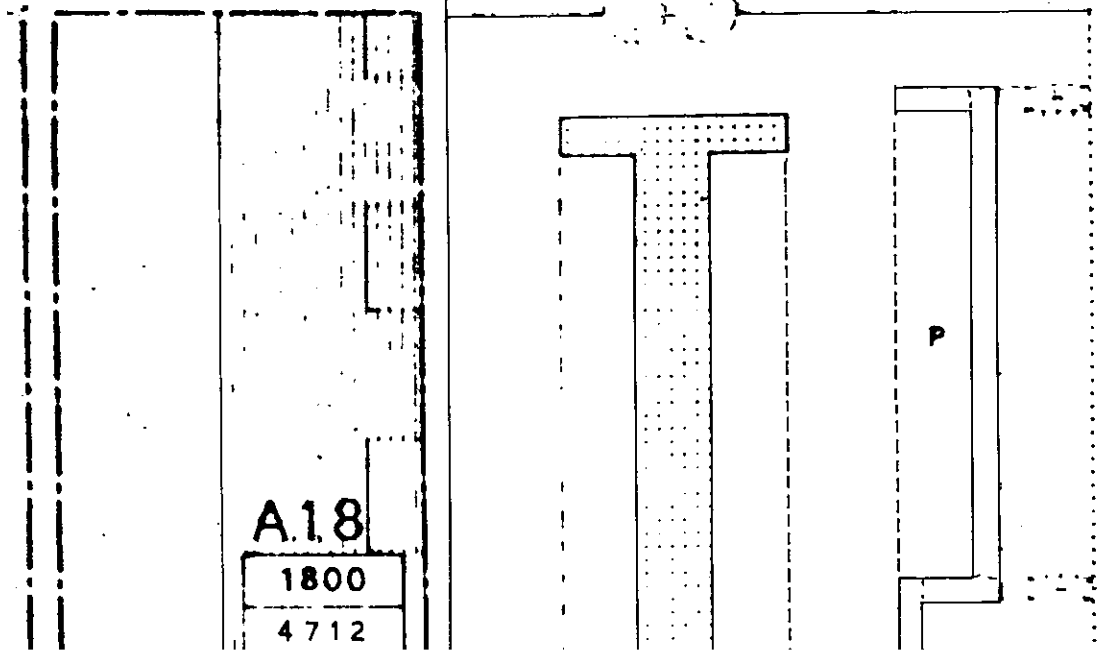

AT

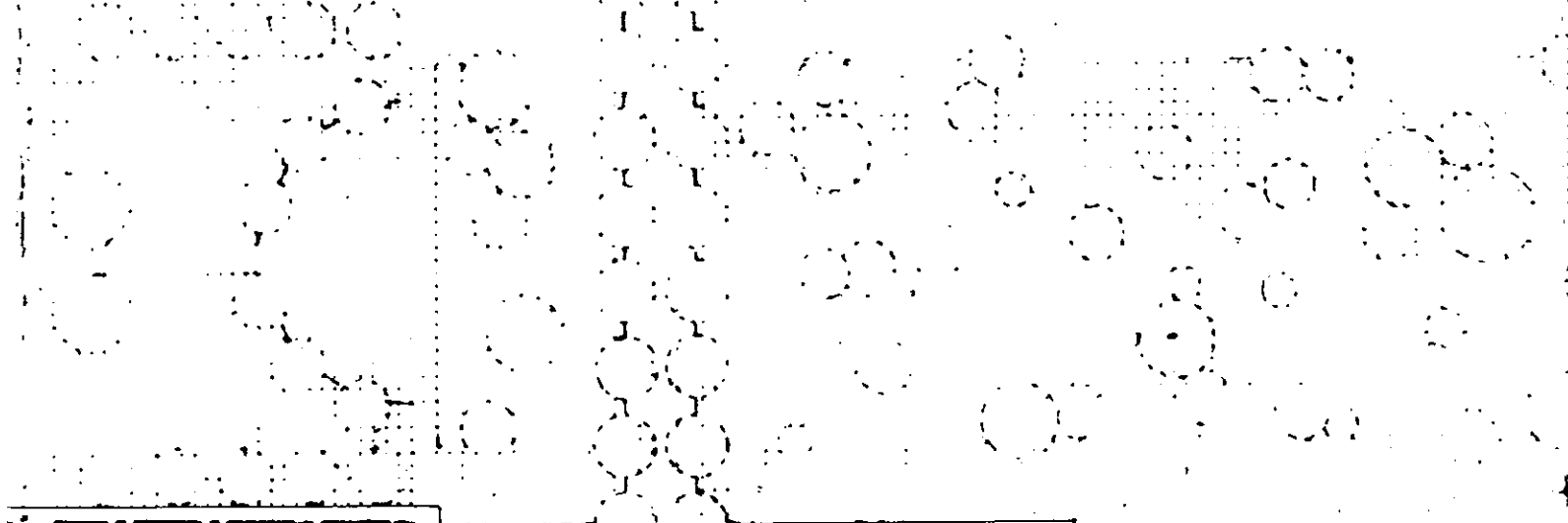
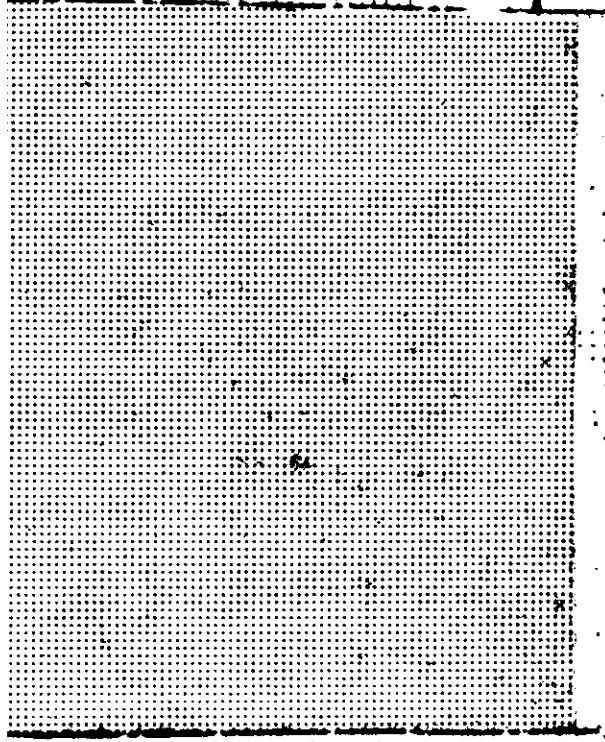
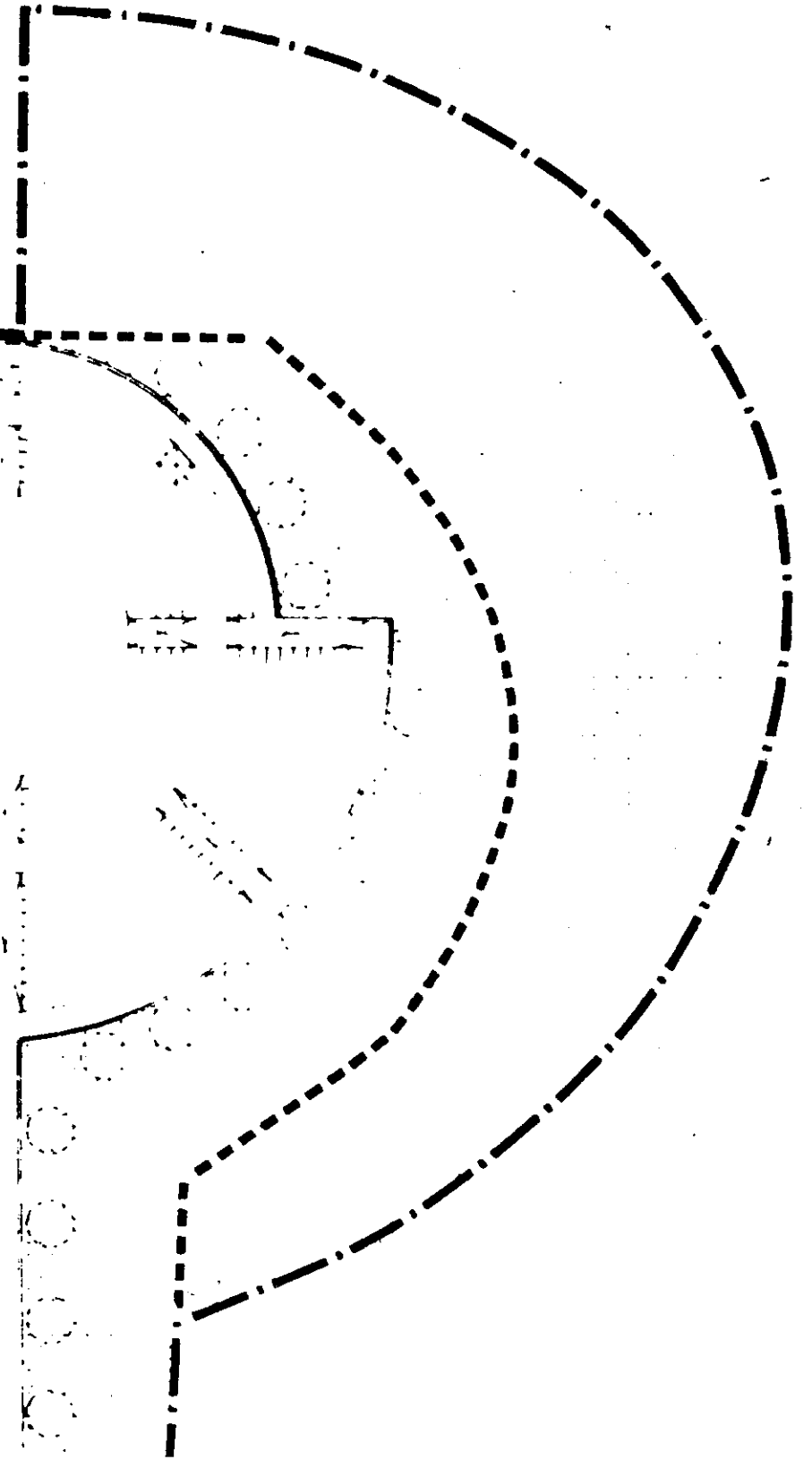

1543

A.13

1800
4712

A.14

1800
4712

A.15

1800
4712

A.16

1800
4712

A.17

1800
4712

A.18

1800
4712

C2
3084
8500

B1B
1725
PT.centro
civico
MQ 250
PI residenza
MC 750

B1A
3225
Art. MC 925
ComMC 6775

B2
6226
12050

A.11
1800
4712

A.12
1800
4712

A.13
1800
4712

P

P

P

P

P

P

A

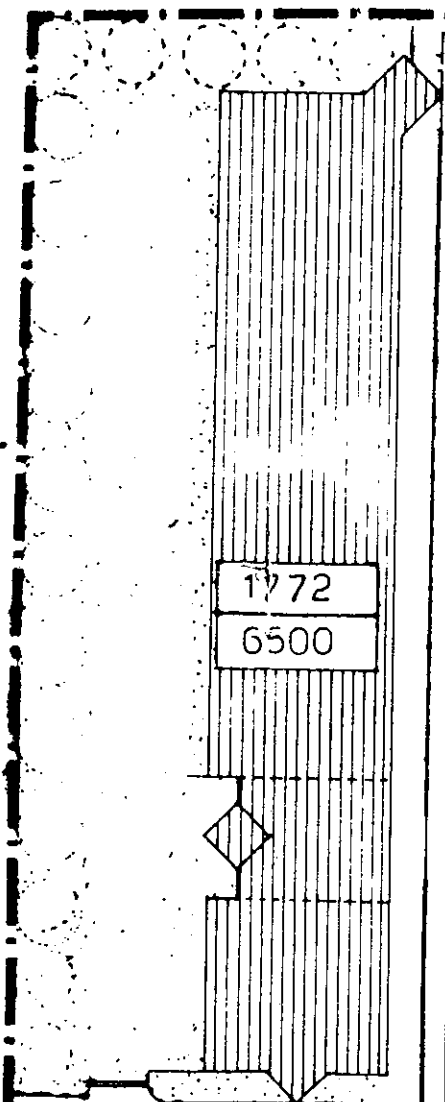

1772
6500

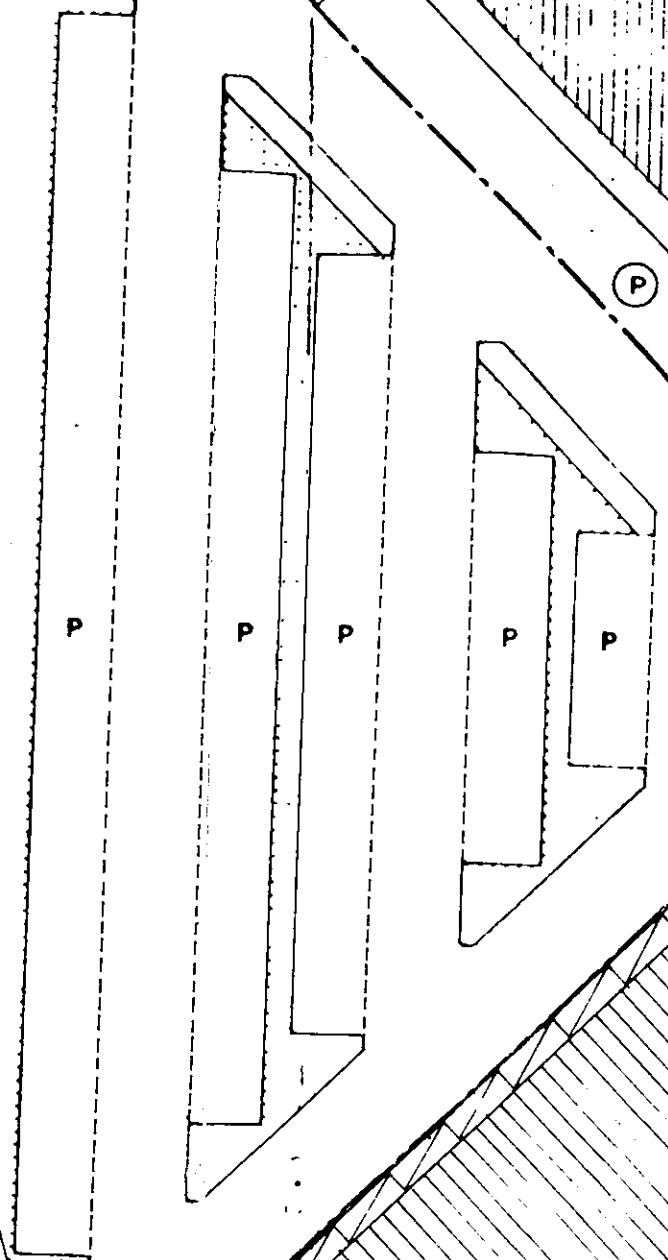
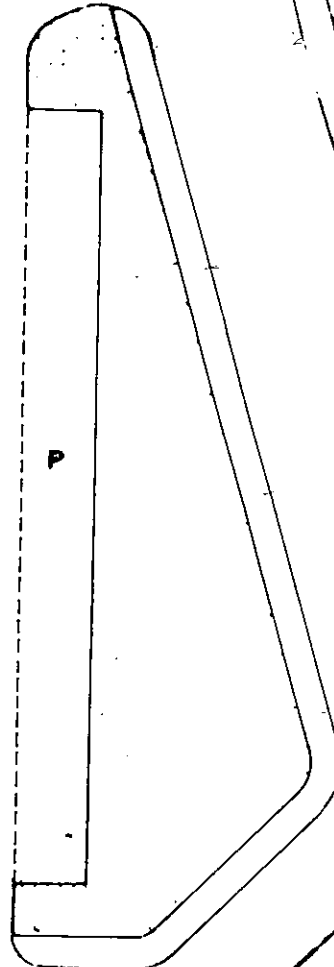

P

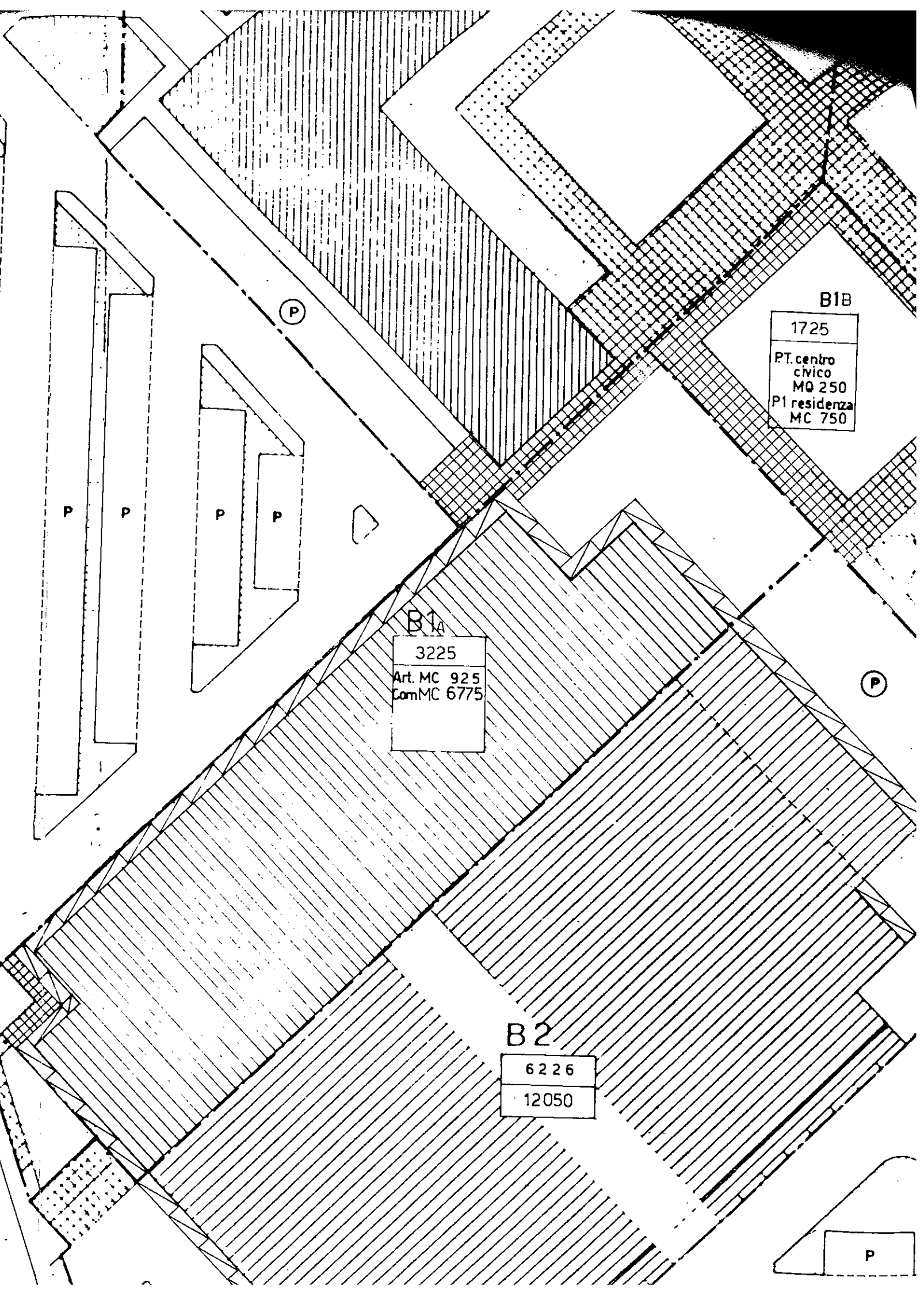

B1
3225
Art. MC 925
Com MC 6775

B2
6226
12050

B1B
1725
PT. centro
civico
MQ 250
P1 residenza
MC 750

P

P

A18

1800

4712

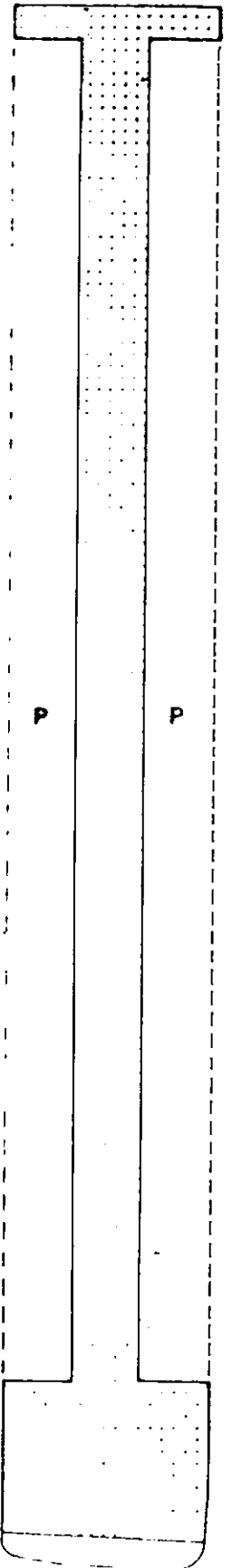

P

AS

P

P

A24

940

4550

P

anel

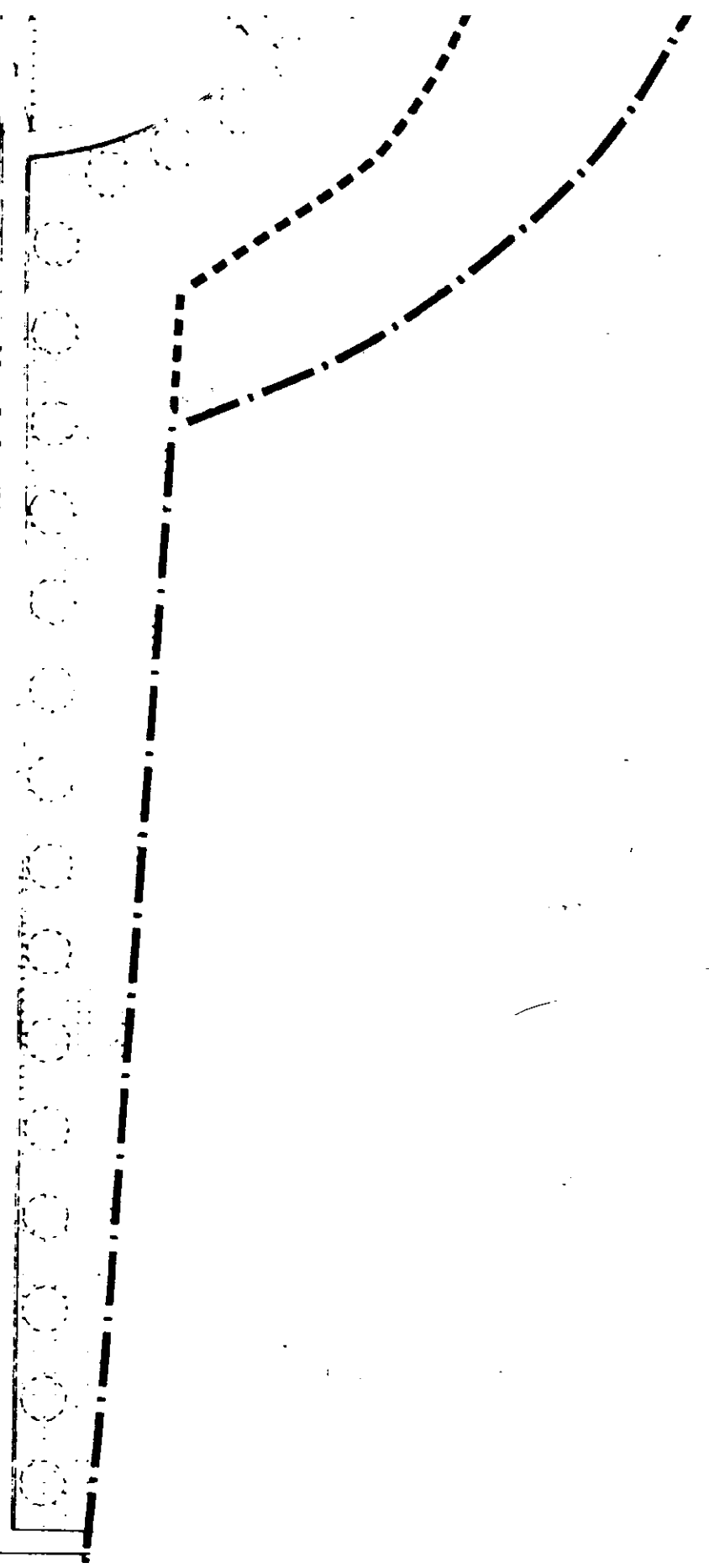

A.1.2

1800
4 712

A.1.3

1800
4 712

A.1.4

1800
4 712

A.1.5

1800
4 712

A.1.6

1800
4 712

A.1.7

1800
4 712

A.1.

1800
4 712

A.2.1

940
4 550

A.2.2

940
4 550

A.2.3

940
4 550

A.2.4

940
4 550

P

P

P

P

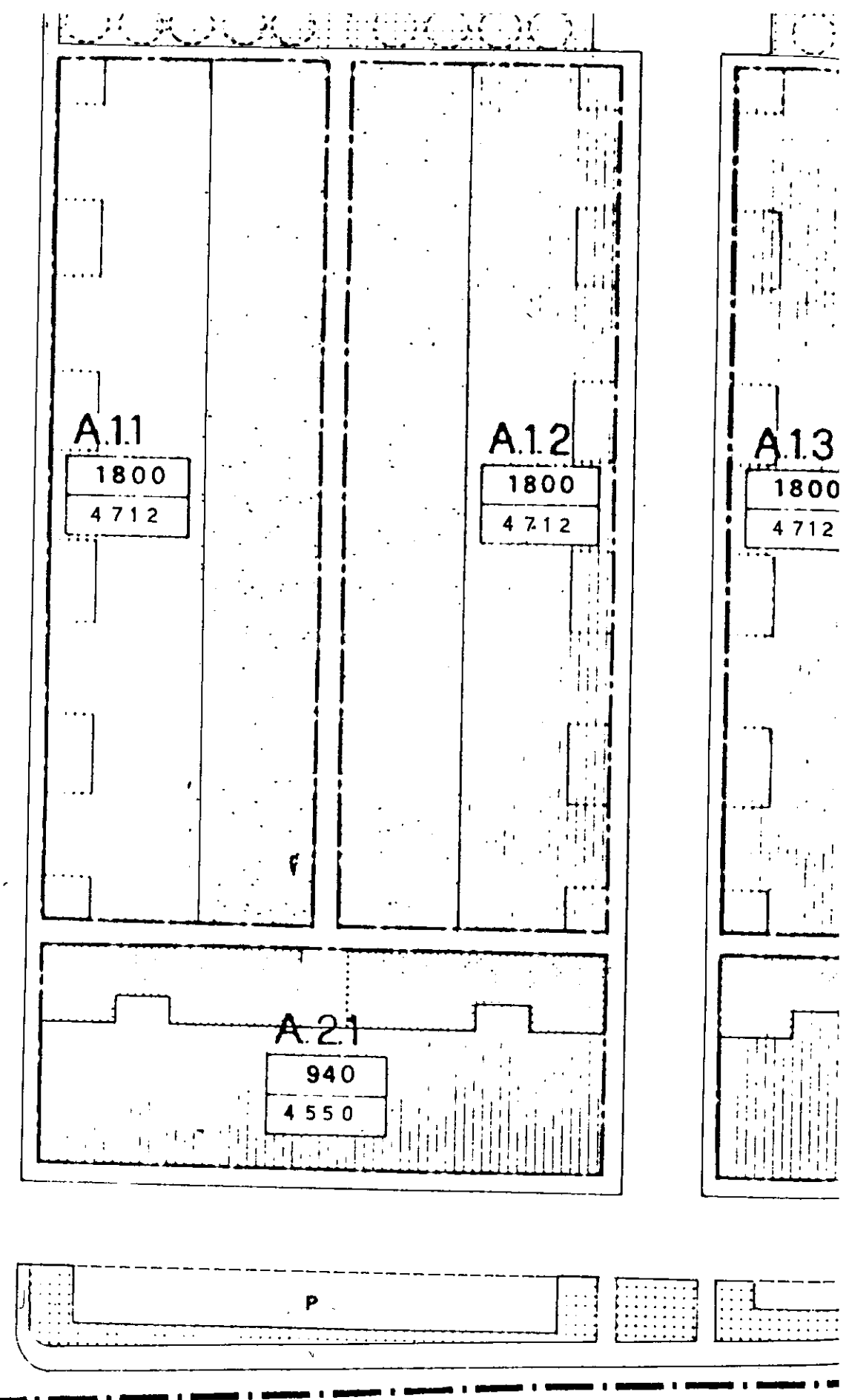
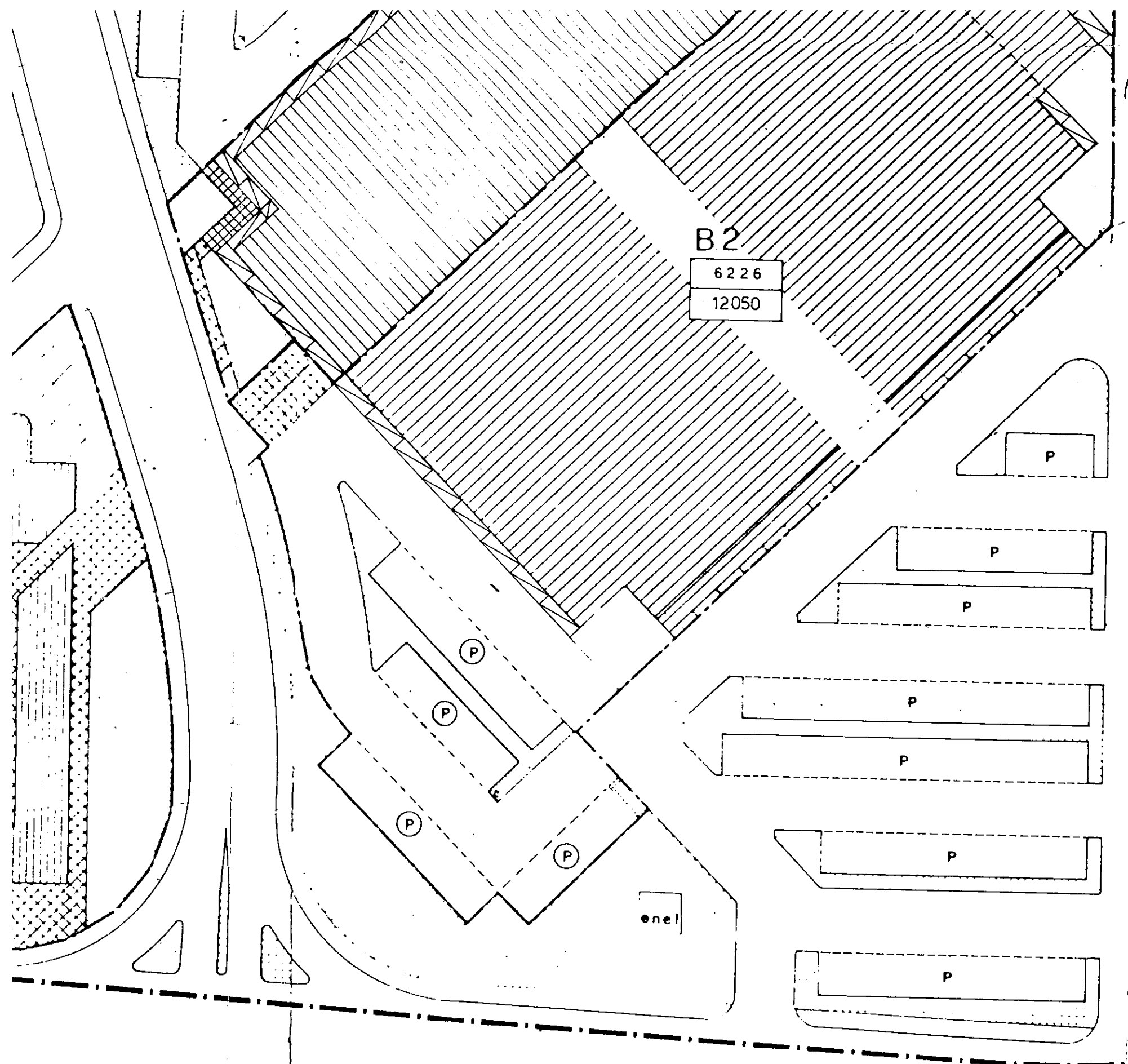

1772
6500

P

B2
6226
12050

